



Self-Aligning Brackets



UCF

Square flanged self-aligning brackets



- **Base**
Glass-fibre reinforced polyamide based (PA) technopolymer, black colour, matte finish.
- **Bushings and washers**
AISI 304 stainless steel.
- **Bearing**
High quality with traceability codes. Chrome steel.
- **Lubricator**
Nickel-plated brass.
- **Packing rings**
NBR rubber.
- **Cap**
Glass-fibre reinforced polypropylene based (PP) technopolymer, RAL 7015 grey colour, matte finish.
Closed cap for head bracket or for pass-through shafts.
- **Standard executions**
 - **UCF-T**: head bracket with closed cap.
 - **UCF-P**: bracket for pass-through shaft with cap and NBR rubber packing ring for rotating shafts.



Features and applications

Overall dimensions are in compliance with ISO 3228.
A system of completely sealed packing rings assures the protection of the bearing from dirt ingress. Max shaft misalignment = 2,5°.

Instructions of use

Assembly with shafts without end stops. For optimum operation, we recommend periodic lubrication with a common grease resistant to high temperatures and oxidation.

Special executions on request

- AISI 440C stainless steel bearing.
- Bearing in inch sizes.
- Brackets for shafts with diameters in different sizes.
- Brackets in antibacterial material or in polypropylene based (PP) technopolymer, packing rings and oil seal type VITON®*.

* Registered trademark by DuPont Dow Elastomers.

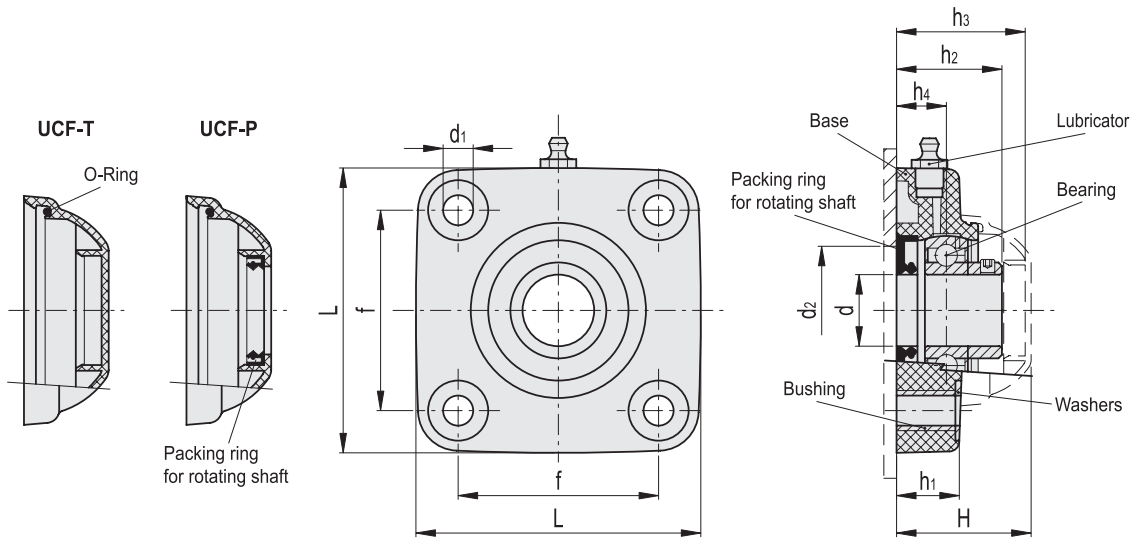
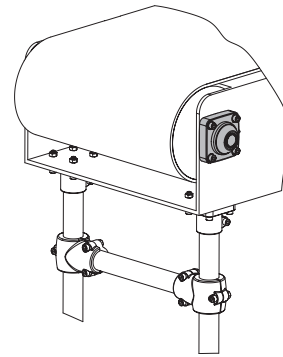

Standard Elements		Main dimensions										Bearing static load	Bearing dynamic load	Bracket load	⚖	
Code	Description	d	d1	d2 min	d2 max	H	L	f	h1	h2	h3	h4	[N]	[N]	[N]	g
419551	UCF.205-A-25-T	25	10.5	45	50	49	99	70	22	36	47	17	7000	14000	17000	445
419561	UCF.206-A-30-T	30	10.5	50	60	56	113	83	26	41	54	20	11000	19000	17000	511
419531	UCF.205-A-25-P	25	10.5	45	50	49	99	70	22	36	-	17	7000	14000	17000	452
419541	UCF.206-A-30-P	30	10.5	50	60	56	113	83	26	41	-	20	11000	19000	17000	518

UCFL

Oval flanged self-aligning brackets



- **Base**
Glass-fibre reinforced polyamide based (PA) technopolymer, black colour, matte finish.
- **Bushings and washers**
AISI 304 stainless steel.
- **Bearing**
High quality with traceability codes. Chrome steel.
- **Lubricator**
Nickel-plated brass.
- **Packing rings**
NBR rubber.
- **Cap**
Glass-fibre reinforced polypropylene based (PP) technopolymer, RAL 7015 grey colour, matte finish.
Closed cap for head bracket or for pass-through shafts.
- **Standard executions**
 - **UCFL-T**: head bracket with closed cap.
 - **UCFL-P**: bracket for pass-through shaft with cap and NBR rubber packing ring for rotating shafts.

Features and applications

Overall dimensions are in compliance with ISO 3228.
A system of completely sealed packing rings assures the protection of the bearing from outdoor environment. Max shaft misalignment = 2,5°.

Instructions of use

Assembly with shafts without end stops. For optimum operation, we recommend periodic lubrication with a common grease resistant to high temperatures and oxidation.

Special executions on request

- AISI 440C stainless steel bearing.
- Bearing in inch sizes.
- Brackets for shafts with diameters in different sizes.
- Brackets in antibacterial material or in polypropylene based (PP) technopolymer, packing rings and oil seal type VITON®*.

* Registered trademark by DuPont Dow Elastomers.

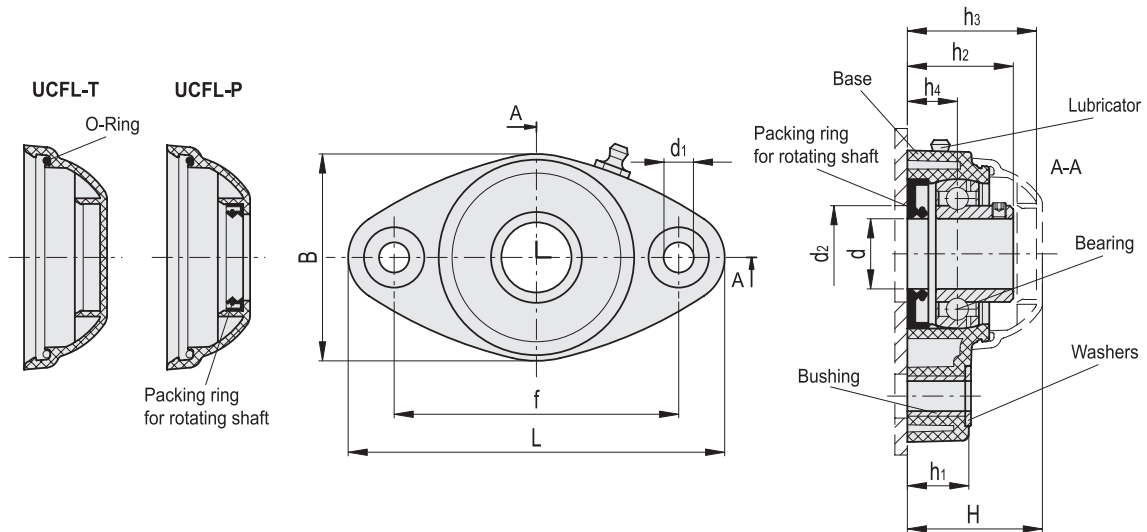
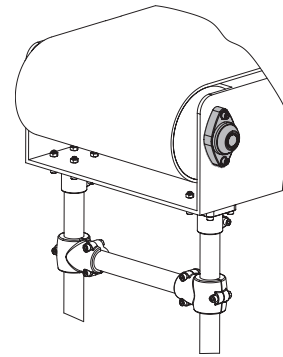

Standard Elements		Main dimensions											Bearing static load	Bearing dynamic load	Bracket load	△	
Code	Description	d	d1	d2 min	d2 max	H	L	B	f	h1	h2	h3	h4	[N]	[N]	[N]	g
419552	UCFL.205-B-25-T	25	10.5	45	50	49	131	72	99	22	36	47	17	7000	14000	10000	294
419562	UCFL.206-B-30-T	30	10.5	50	60	56	149	86	117	26	41	54	20	11000	19000	13000	397
419532	UCFL.205-B-25-P	25	10.5	45	50	49	131	72	99	22	36	-	17	7000	14000	10000	300
419542	UCFL.206-B-30-P	30	10.5	50	60	56	149	86	117	26	41	-	20	11000	19000	13000	404

Self-aligning brackets for shafts at 90°



- **Base**
Glass-fibre reinforced polyamide based (PA) technopolymer, black colour, matte finish.
- **Bushings, washers and stop ring**
AISI 304 stainless steel.
- **Bearing**
High quality with traceability codes. Chrome steel.
- **Lubricator**
Nickel-plated brass.
- **Packing rings**
NBR rubber.
- **Cap**
Glass-fibre reinforced polypropylene based (PP) technopolymer, RAL 7015 grey colour, matte finish.
Closed cap for head bracket or for pass-through shafts.
- **Standard executions**
 - **UCP-T**: head bracket with closed cap.
 - **UCP-P**: bracket for pass-through shaft with cap and NBR rubber packing ring for rotating shafts.



Features and applications

Overall dimensions are in compliance with ISO 3228.
A system of completely sealed packing rings assures the protection of the bearing from dirt ingress. Max shaft misalignment = 2,5°.

Instructions of use

Assembly with shafts without end stops. For optimum operation, we recommend periodic lubrication with a common grease resistant to high temperatures and oxidation.

Special executions on request

- AISI 440C stainless steel bearing.
- Bearing in inch sizes.
- Brackets for shafts with diameters in different sizes.
- Brackets in antibacterial material or in polypropylene based (PP) technopolymer, packing rings and oil seal type VITON®*.

* Registered trademark by DuPont Dow Elastomers.

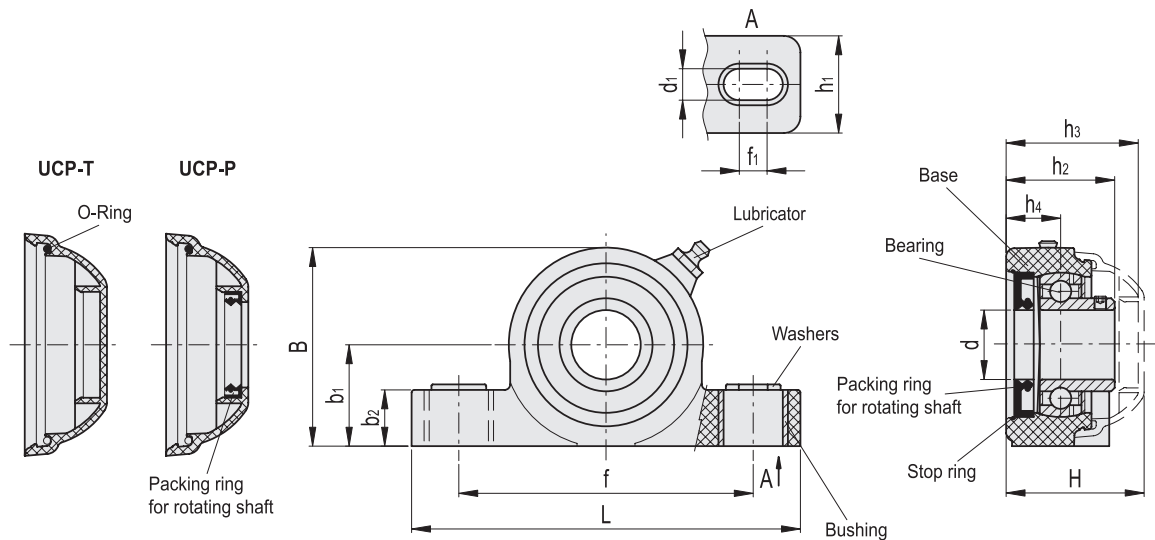
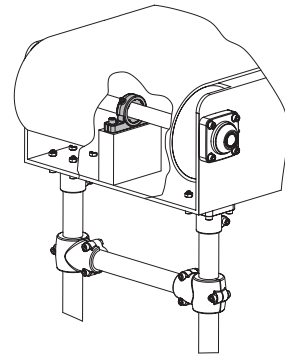

Standard Elements		Main dimensions												Bearing static load	Bearing dynamic load	Bracket load	⚖	
Code	Description	d	d1	f1	H	L	B	f	b1	b2	h1	h2	h3	h4	[N]	[N]	[N]	g
419553	UCP.205-C-25-T	25	13	10	51.7	140	71.5	106	36.5	20	35	39	49	19.6	7000	14000	6000	333
419563	UCP.206-C-30-T	30	13	10	55.7	163	84.5	121	43	20	36	41.7	53	20.7	11000	19000	9000	456
419533	UCP.205-C-25-P	25	13	10	51.7	140	71.5	106	36.5	20	35	39	-	19.6	7000	14000	6000	339
419543	UCP.206-C-30-P	30	13	10	55.7	163	84.5	121	43	20	36	41.7	-	20.7	11000	19000	9000	463

UCFB

Side flange self-aligning brackets



• Base

Glass-fibre reinforced polyamide based (PA) technopolymer, black colour, matte finish.

• Bushings and washers

AISI 304 stainless steel.

• Bearing

High quality with traceability codes. Chrome steel.

• Lubricator

Nickel-plated brass.

• Packing rings

NBR rubber.

• Cap

Glass-fibre reinforced polypropylene based (PP) technopolymer, RAL 7015 grey colour, matte finish.

Closed cap for head bracket or for pass-through shafts.

• Standard executions

- **UCFB-T**: head bracket with closed cap.

- **UCFB-P**: bracket for pass-through shaft with cap and NBR rubber packing ring for rotating shafts.

Features and applications

Overall dimensions are in compliance with ISO 3228.

A system of completely sealed packing rings assures the protection of the bearing from dirt ingress. Max shaft misalignment = 2,5°.

Instructions of use

Assembly with shafts without end stops. For optimum operation, we recommend periodic lubrication with a common grease resistant to high temperatures and oxidation.

Special executions on request

- AISI 440C stainless steel bearing.

- Bearing in inch sizes.

- Brackets for shafts with diameters in different sizes.

- Brackets in antibacterial material or in polypropylene based (PP) technopolymer, packing rings and oil seal type VITON®*.

* Registered trademark by DuPont Dow Elastomers.

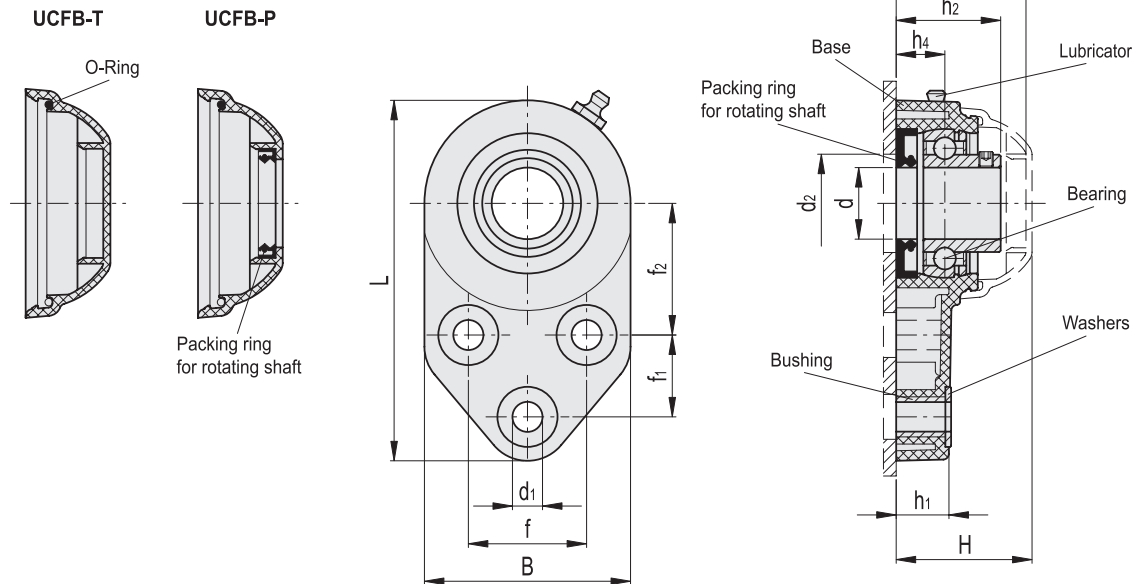
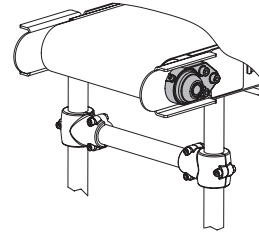

Standard Elements		Main dimensions														Bearing static load	Bearing dynamic load	Bracket load	△
Code	Description	d	d1	d2 min	d2 max	H	L	B	f	f1	f2	h1	h2	h3	h4	[N]	[N]	[N]	g
419554	UCFB.205-D-25-T	25	10.5	45	50	49.5	126	72	41.3	28.6	46	19	36.5	47	17	7000	14000	9000	353
419564	UCFB.206-D-30-T	30	10.5	50	60	55.7	142	85	47.6	32	52.4	26.3	41.7	53.2	20.7	11000	19000	11000	469
419534	UCFB.205-D-25-P	25	10.5	45	50	49.5	126	72	41.3	28.6	46	19	36.5	-	17	7000	14000	9000	359
419544	UCFB.206-D-30-P	30	10.5	50	60	55.7	142	85	47.6	32	52.4	26.3	41.7	-	20.7	11000	19000	11000	476

Flexible Automation Components



1 MSX Connecting clamps

For the positioning of photocells or other devices on packaging lines by using tubes with round or square cross section.
Stainless steel screws.

INOX
Stainless Steel



1 MSR Connecting clamps

For the positioning of photocells or other devices on packaging lines by using aluminium slotted connecting tubes preventing free rotation.
Black-oxide steel screws.



2 BAS2 • BAS3 Bipod or tripod support bases

For supporting machines, conveyors, elevator belts in the beverage, food and pharmaceutical industry, automated transport.
Zinc-plated steel or AISI 304 stainless steel screws.

INOX
Stainless Steel



2 BAG2-120 • BAS2-180 Bipod support bases and connection joint

For supporting the two lateral sides of conveyors, discharge belts and elevator belts in the beverage, food and pharmaceutical industry, automated transport.
Zinc-plated steel or AISI 304 stainless steel screws.

INOX
Stainless Steel



3 TTA • TTb Bearing heads

For supporting conveyors by means of steel tubes.
Zinc-plated steel or AISI 304 stainless steel screws.

INOX
Stainless Steel



4 TSLA • TSLB Side mounting top brackets

For use on conveyors, for supporting lateral sides by means of steel tubes.
Zinc-plated steel or AISI 304 stainless steel screws.

INOX
Stainless Steel



5 GC. Connecting joints

For connecting tubes with round or square cross section between the lateral sides of conveyors.
Zinc-plated steel or AISI 304 stainless steel screws.

INOX
Stainless Steel



ND.Q • NDX.Q • NDX.T Square and round end-caps

For use on round and square tubes for supporting machines, conveyors, elevator belts in the beverage, food and pharmaceutical industry, automated transport by using levelling elements.
Brass tapped boss.



6 SPF • SPR • SPR.V Guide rail brackets for linear and angular positioning

For fitting bearing pins, for supporting straight or curved side guides.
Zinc-plated steel or AISI 304 stainless steel screws.

INOX
Stainless Steel



7 LV.A • LVQ.A • LV.F • LVQ.F Levelling elements with or without ground mounting

For supporting machines, conveyors, elevator belts in the beverage, food and pharmaceutical industry, automated transport by using square or round end caps.
Zinc-plated steel or AISI 304 stainless steel articulated stem.

INOX
Stainless Steel



8 MPG • MPG-2 • MPG-S Guide rail clamps

For use on conveyors for supporting side guides.
Zinc-plated steel or AISI 304 stainless steel screws.

INOX
Stainless Steel

Flexible Automation Components





ELESA S.p.A.
Via Pompei 29
20900 Monza (MB) ITALY
Phone: +39 039 28 11.1
Fax: +39 039 83 63 51
www.elesa.com
info@elesa.com

OTTO GANTER GmbH & Co.KG
Triberger Straße 3
78120 Furtwangen GERMANY
Phone: +49 7723 65 07 130
Fax: +49 7723 65 07 165
www.ganter-griff.com
info@ganter-griff.de



www.elesa-ganter.com