

B.259-CLEAN



Knurled knobs

Duroplast, easy cleaning

MATERIAL

Phenolic based (PF) Duroplast. White similar to RAL 9002, glossy finish.

STANDARD EXECUTION

AISI 303 stainless steel boss, threaded blind hole.

FEATURES AND APPLICATIONS

B.259-CLEAN knob, thanks to its white colour and glossy finish, is particularly suitable for applications on medical and hospital equipment and on food processing machines whose parts, for hygienic reasons, must be frequently cleaned. Its solid shape without cavities prevents unhealthy residues from depositing.



ELESA Original design

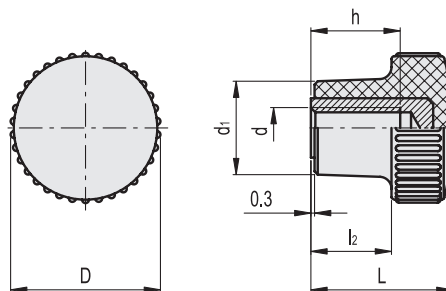

STAINLESS STEEL

Code	Description	D	d6H	L	d1	l2	h	⚖️
151102	B.259/20-SST-M6 CLEAN	21	M6	25	13	12	12	11
151112	B.259/25-SST-M8 CLEAN	26	M8	28	16	15	13	19
151123	B.259/30-SST-M10 CLEAN	31	M10	32	19	17	17	29

Clamping knobs 2