

## Bridge handles

### Technopolymer

#### MATERIAL

Glass-fibre reinforced polyamide based (PA) technopolymer, grey-black colour, matte finish.

#### SCREW-COVERS

- ECA.B: glass-fibre reinforced polyamide based (PA) technopolymer, in Elecolors colours, matte finish.

Supplied, push-fit assembly, removable by a screwdriver. Available also as accessory sold separately (see table).

#### STANDARD EXECUTION

Pass-through holes for front or rear mounting by means of cylindrical-head screws with hexagon socket, hexagonal-head screws or nuts.

Suggested tightening torque:

- back mounting with plain holes: 10 [Nm]
- front mounting with plain or tapped holes: 10 [Nm].

#### TECHNICAL DATA

The values F1, F2, L1 and L2 indicated in the table were obtained during breaking tests carried out with the appropriate dynamometric equipment under the test conditions shown in the figure with ambient temperature.

#### ACCESSORIES ON REQUEST

ECA.B: screw-covers in Elecolors colours (see table).

C1	C2	C3	C4	C5	C6	C17
RAL7021	RAL2004	RAL7035	RAL1021	RAL5024	RAL3000	RAL6017

#### ECA.B

Code	Description	Caps for
29832-*	ECA.B2-*	EBP-L.335

\* Complete with colour index (C1, ..., C17).



**ERGOSTYLE**® ELESA Original design

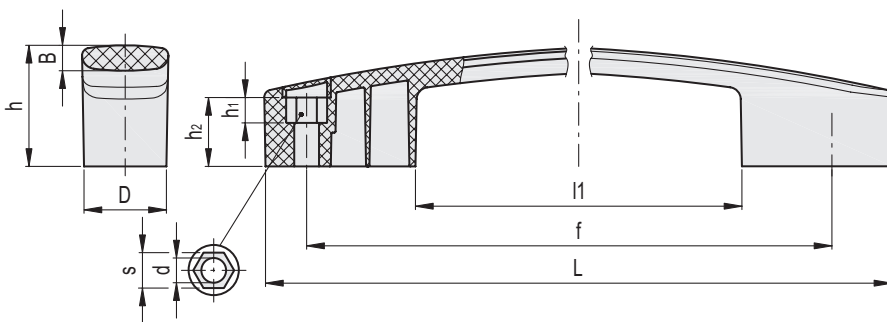
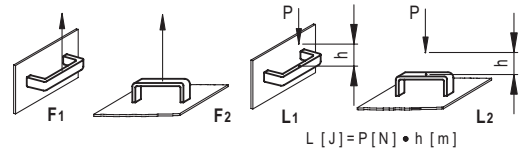

\* Complete with colour index, example: 260451-C2 EBP-L.335-8-C2

C1	C2	C3	C4	C5	C6	C17
RAL7021	RAL2004	RAL7035	RAL1021	RAL5024	RAL3000	RAL6017

Code	Description	L	f	d	s	D	h	h1	h2	B	l1	F1* [N]	F1# [N]	F2* [N]	F2# [N]	L1# [J]	L2# [J]	⚖️
260451-*	EBP-L.335-8-*	335	300±1	8.5	13	35.5	51	10.5	28.5	10.5	210	1000	2500	1000	5000	44	14	205
260452-*	EBP-L.335-10-*	335	300±1	10.5	17	35.5	51	10.5	28.5	10.5	210	1000	2500	1000	5000	44	14	201

\* Maximum working load  
# Load at breakage.