

Tubular handles

Technopolymer and aluminium

HANDLE SHANKS

Glass-fibre reinforced polyamide based (PA) technopolymer, matte finish.

COVERS

- ECAT: polyamide based (PA) technopolymer, in Elecolors colours, glossy finish, press-fit assembly. Supplied, removable by a screwdriver.

Available also as accessory sold separately (see table).

ANTI-ROTATION TUBE ASSEMBLING SYSTEM

Special expansion-assembly system between the tube and the handle shanks to prevent rotation during operation.

STANDARD EXECUTIONS

Pass-through holes for cylindrical-head screws with hexagon socket, hexagonal-head screws or standard lock nuts.

- **ETH-EP:** aluminium tube, epoxy resin coating, metalflake graphite colour, matte finish. Highly resistant to wear, scratches and chemical agents. Avoid continuous and prolonged contact with boiling water or steam. Side shanks in grey-black colour.

- **ETH-AN:** Anodised aluminium tube, natural colour. Side shanks in grey-black colour.

Suggested tightening torque:

- back mounting with plain holes: 8 [Nm]

- front mounting with plain or tapped holes: 15 [Nm].

ERGONOMY AND DESIGN

The large diameter of the tube offers a good and comfortable grip; the antirotation assembly system of the handle shanks to the tube has been developed to offer a firm and secure manoeuvrability during operations.

TECHNICAL DATA

Tensile stress: F2 values reported in the table are the result of breaking tests carried out with the appropriate dynamometric equipment under the test conditions shown in the figure with ambient temperature.

SPECIAL EXECUTIONS ON REQUEST

Different lengths.

ACCESSORIES ON REQUEST

- DS-ETH: spacer sleeves in glass-fibre reinforced polyamide based (PA) technopolymer to increase the distance between the handle and the fitting surface.

- ECAT: polyamide based (PA) technopolymer closing caps, in Elecolors colours, glossy finish, press-fit assembly.



ECAT

| Code | Description | Cover for |
|---------|-------------|-----------|
| 29871-* | ECA.T1-* | ETH.28 |
| 29872-* | ECA.T2-* | ETH.35 |

* Complete with colour index (C1, ..., C17).

DS-ETH

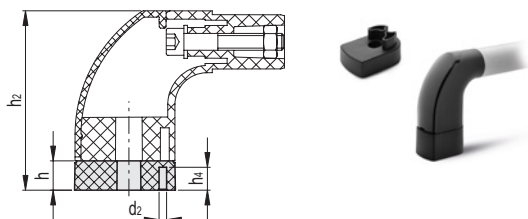

| Code | Description | d2 | h | h2 | h4 | For handle | ⚖️ |
|-------|--------------|----|------|-------|------|------------|----|
| 15251 | DS-ETH.35-16 | 4 | 16 | 101.5 | 12.5 | ETH.35 | 24 |
| 15253 | DS-ETH.35-32 | 4 | 32.5 | 118 | 15 | ETH.35 | 45 |

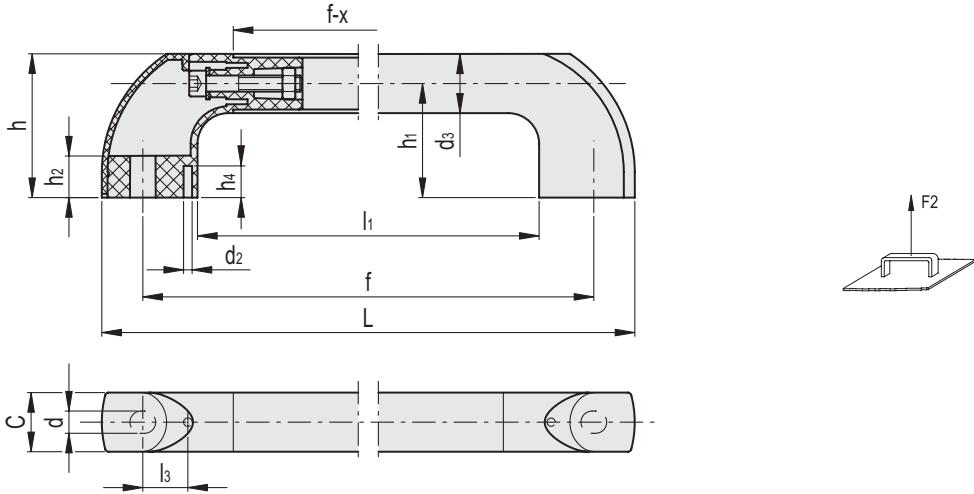

* Complete with colour index, example: 262151-C2 ETH.28-300-EP-C2

- C1 RAL7021
- C2 RAL2004
- C3 RAL7035
- C4 RAL1021
- C5 RAL5024
- C6 RAL3000
- C17 RAL6017

ETH-EP

| Code | Description | d3 | f±1 | L | d | h | h1 | h2 | h4 | l1 | l3 | d2 | C | x | F2 [N]* | F2 [N]# | ⚖️ |
|----------|------------------|------|------|------|------|----|------|----|----|-----|------|----|----|----|---------|---------|-----|
| 262151-* | ETH.28-300-EP-* | 27.5 | 300 | 339 | 10.5 | 68 | 54 | 20 | 15 | 248 | 20.3 | 4 | 28 | 86 | 2400 | 2800 | 235 |
| 262155-* | ETH.28-400-EP-* | 27.5 | 400 | 439 | 10.5 | 68 | 54 | 20 | 15 | 348 | 20.3 | 4 | 28 | 86 | 2000 | 2300 | 268 |
| 262161-* | ETH.28-500-EP-* | 27.5 | 500 | 539 | 10.5 | 68 | 54 | 20 | 15 | 448 | 20.3 | 4 | 28 | 86 | 1800 | 2000 | 301 |
| 262165-* | ETH.28-600-EP-* | 27.5 | 600 | 639 | 10.5 | 68 | 54 | 20 | 15 | 548 | 20.3 | 4 | 28 | 86 | 1200 | 1500 | 335 |
| 262171-* | ETH.28-700-EP-* | 27.5 | 700 | 739 | 10.5 | 68 | 54 | 20 | 15 | 648 | 20.3 | 4 | 28 | 86 | 900 | 1200 | 368 |
| 262211-* | ETH.35-300-EP-* | 34.5 | 300 | 357 | 10.5 | 85 | 67.5 | 28 | 15 | 251 | 18.5 | 4 | 35 | 91 | 3000 | 3100 | 397 |
| 262215-* | ETH.35-400-EP-* | 34.5 | 400 | 457 | 10.5 | 85 | 67.5 | 28 | 15 | 351 | 18.5 | 4 | 35 | 91 | 2700 | 2800 | 456 |
| 262221-* | ETH.35-500-EP-* | 34.5 | 500 | 557 | 10.5 | 85 | 67.5 | 28 | 15 | 451 | 18.5 | 4 | 35 | 91 | 2500 | 2600 | 515 |
| 262225-* | ETH.35-600-EP-* | 34.5 | 600 | 657 | 10.5 | 85 | 67.5 | 28 | 15 | 551 | 18.5 | 4 | 35 | 91 | 1900 | 2100 | 574 |
| 262231-* | ETH.35-700-EP-* | 34.5 | 700 | 757 | 10.5 | 85 | 67.5 | 28 | 15 | 651 | 18.5 | 4 | 35 | 91 | 1900 | 2100 | 633 |
| 262246-* | ETH.35-1000-EP-* | 34.5 | 1000 | 1057 | 10.5 | 85 | 67.5 | 28 | 15 | 951 | 18.5 | 4 | 35 | 91 | 1200 | 1400 | 810 |

ETH-AN

| Code | Description | d3 | f±1 | L | d | h | h1 | h2 | h4 | l1 | l3 | d2 | C | x | F2 [N]* | F2 [N]# | ⚖️ |
|----------|------------------|------|------|------|------|----|------|----|----|-----|------|----|----|----|---------|---------|-----|
| 262153-* | ETH.28-300-AN-* | 27.5 | 300 | 339 | 10.5 | 68 | 54 | 20 | 15 | 248 | 20.3 | 4 | 28 | 86 | 2400 | 2800 | 235 |
| 262157-* | ETH.28-400-AN-* | 27.5 | 400 | 439 | 10.5 | 68 | 54 | 20 | 15 | 348 | 20.3 | 4 | 28 | 86 | 2000 | 2300 | 268 |
| 262163-* | ETH.28-500-AN-* | 27.5 | 500 | 539 | 10.5 | 68 | 54 | 20 | 15 | 448 | 20.3 | 4 | 28 | 86 | 1800 | 2000 | 301 |
| 262167-* | ETH.28-600-AN-* | 27.5 | 600 | 639 | 10.5 | 68 | 54 | 20 | 15 | 548 | 20.3 | 4 | 28 | 86 | 1200 | 1500 | 335 |
| 262173-* | ETH.28-700-AN-* | 27.5 | 700 | 739 | 10.5 | 68 | 54 | 20 | 15 | 648 | 20.3 | 4 | 28 | 86 | 900 | 1200 | 368 |
| 262213-* | ETH.35-300-AN-* | 34.5 | 300 | 357 | 10.5 | 85 | 67.5 | 28 | 15 | 251 | 18.5 | 4 | 35 | 91 | 3000 | 3100 | 397 |
| 262217-* | ETH.35-400-AN-* | 34.5 | 400 | 457 | 10.5 | 85 | 67.5 | 28 | 15 | 351 | 18.5 | 4 | 35 | 91 | 2700 | 2800 | 456 |
| 262223-* | ETH.35-500-AN-* | 34.5 | 500 | 557 | 10.5 | 85 | 67.5 | 28 | 15 | 451 | 18.5 | 4 | 35 | 91 | 2500 | 2600 | 515 |
| 262227-* | ETH.35-600-AN-* | 34.5 | 600 | 657 | 10.5 | 85 | 67.5 | 28 | 15 | 551 | 18.5 | 4 | 35 | 91 | 1900 | 2100 | 574 |
| 262233-* | ETH.35-700-AN-* | 34.5 | 700 | 757 | 10.5 | 85 | 67.5 | 28 | 15 | 651 | 18.5 | 4 | 35 | 91 | 1900 | 2100 | 633 |
| 262248-* | ETH.35-1000-AN-* | 34.5 | 1000 | 1057 | 10.5 | 85 | 67.5 | 28 | 15 | 951 | 18.5 | 4 | 35 | 91 | 1200 | 1400 | 810 |

* Maximum working load

Load at breakage

