

Lobe threaded nut

Technopolymer

MATERIAL

Glass-fibre reinforced polyamide based (PA) technopolymer, black colour, matte finish.

STANDARD EXECUTIONS

- **GFL-B**: brass boss, threaded through hole.
- **GFL-p**: zinc-plated steel threaded stud.

FEATURES AND APPLICATIONS

The ergonomic seven-lobe shape allows an effective grip to the operator when tightening. Suitable for axial locking; it can be used as a nut.



ELESA Original design

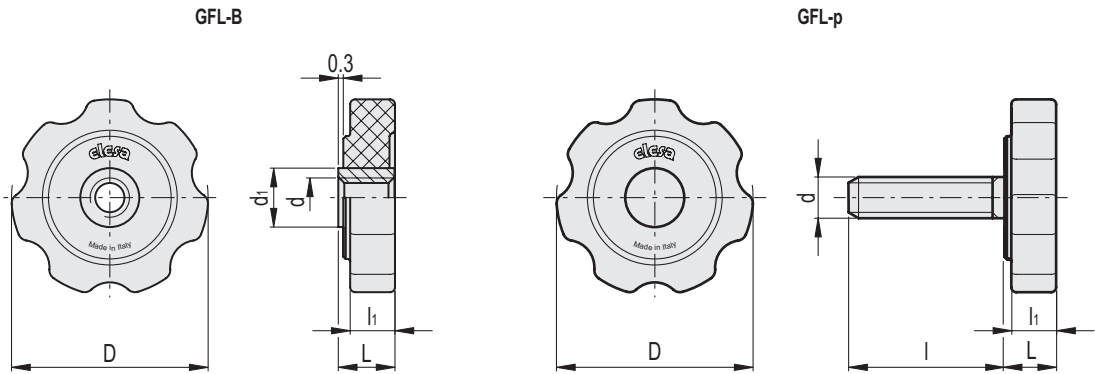

GFL-B

| Code | Description | D | d _{6H} | L | d ₁ | l ₁ | ⚖ |
|--------|--------------|----|-----------------|----|----------------|----------------|----|
| 168540 | GFL.40-B M6 | 40 | M6 | 10 | 12 | 8.5 | 15 |
| 168541 | GFL.40-B M8 | 40 | M8 | 10 | 12 | 8.5 | 17 |
| 168542 | GFL.40-B M10 | 40 | M10 | 10 | 13 | 8.5 | 16 |
| 168571 | GFL.50-B M8 | 50 | M8 | 10 | 12 | 8.5 | 22 |
| 168572 | GFL.50-B M10 | 50 | M10 | 10 | 13 | 8.5 | 24 |

GFL-p

| Code | Description | D | d _{6g} | L | l | l ₁ | ⚖ |
|--------|-----------------|----|-----------------|----|----|----------------|----|
| 168551 | GFL.40 p-M8x20 | 40 | M8 | 10 | 20 | 8.5 | 21 |
| 168553 | GFL.40 p-M8x28 | 40 | M8 | 10 | 28 | 8.5 | 23 |
| 168563 | GFL.40 p-M10x28 | 40 | M10 | 10 | 28 | 8.5 | 32 |
| 168565 | GFL.40 p-M10x38 | 40 | M10 | 10 | 38 | 8.5 | 38 |
| 168583 | GFL.50 p-M8x20 | 50 | M8 | 10 | 20 | 8.5 | 26 |
| 168585 | GFL.50 p-M8x28 | 50 | M8 | 10 | 28 | 8.5 | 32 |
| 168593 | GFL.50 p-M10x28 | 50 | M10 | 10 | 28 | 8.5 | 41 |
| 168597 | GFL.50 p-M10x38 | 50 | M10 | 10 | 38 | 8.5 | 47 |