

Grub screws with thrust pad

Technopolymer thrust pad, SUPER-technopolymer screw

MATERIAL

Glass-fibre reinforced polyamide based (PA) SUPER-technopolymer screw, RAL 9005 (C9) black colour, or RAL 7040 (C33) grey colour. Acetal resin based (POM) technopolymer thrust pad, black colour, matte finish, supplied not assembled.

FEATURES AND APPLICATIONS

GST-SV screws are for use on irregular or non-parallel surfaces due to the thrust pad, which allows clamping without transmitting rotation to the surface to be clamped and protecting it from any scratches. The hexagon socket head allows rapid screwing and unscrewing of the product.

Diameter "d1" of the ball is smaller than diameter "d" of the screw, which allows the screwing from the spherical side.

In addition, GST-SV screws offer:

- Anti-rust.
- Resistance to chemical agents.
- Can also be used in outdoor conditions with excellent durability.
- High mechanical resistance.
- Lightness: suitable for applications that require reduced weight.



Application example

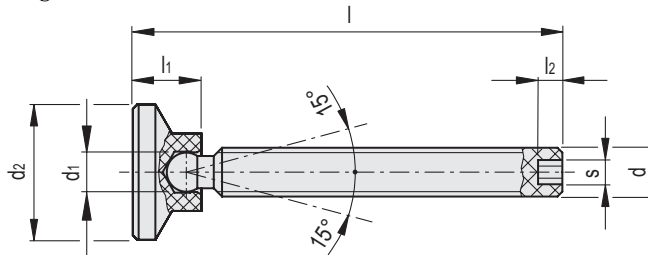
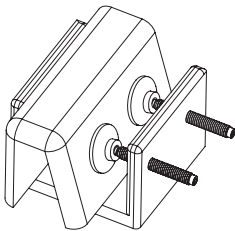

* Complete with colour index, example: 317921-C9 GST-M6x30-SV15-C9

C9
 RAL9005

C33
 RAL7040

Code	Description	d	d1	d2	l	l1	l2	s	ΔΔ
317921-*	GST-M6x30-SV15-*	M6	4.5	15	33.5	7.5	6	2	2
317923-*	GST-M6x40-SV15-*	M6	4.5	15	43.5	7.5	6	2	2
317925-*	GST-M6x50-SV15-*	M6	4.5	15	53.5	7.5	6	2	3
317931-*	GST-M8x40-SV18-*	M8	6	18	44	9	8	3	4
317933-*	GST-M8x50-SV18-*	M8	6	18	54	9	8	3	5
317935-*	GST-M8x63-SV18-*	M8	6	18	67	9	8	3	5
317941-*	GST-M8x40-SV21-*	M8	6	21	45	10	8	3	5
317943-*	GST-M8x50-SV21-*	M8	6	21	55	10	8	3	6
317945-*	GST-M8x63-SV21-*	M8	6	21	68	10	8	3	7
317951-*	GST-M8x40-SV25-*	M8	6	25	45.5	10.5	8	3	6
317953-*	GST-M8x50-SV25-*	M8	6	25	55.5	10.5	8	3	7
317955-*	GST-M8x63-SV25-*	M8	6	25	68.5	10.5	8	3	7
317961-*	GST-M8x40-SV32-*	M8	6	32	46	11	8	3	8
317963-*	GST-M8x50-SV32-*	M8	6	32	56	11	8	3	8
317965-*	GST-M8x63-SV32-*	M8	6	32	69	11	8	3	9
317971-*	GST-M8x40-SV40-*	M8	6	40	48	13	8	3	12
317973-*	GST-M8x50-SV40-*	M8	6	40	58	13	8	3	13
317975-*	GST-M8x63-SV40-*	M8	6	40	71	13	8	3	14