

Revolving handles

Technopolymer

MATERIAL

Polyamide based (PA) technopolymer, black colour, matte finish.

STANDARD EXECUTION

Zinc-plated steel shank, hexagon socket at threaded end.

ERGONOMY

The grooves cut into the cylindrical surface allow the optimization of the grip with the tips of the fingers, due to the small size of the handle.



ELESA Original design

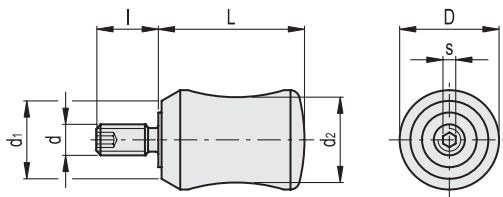

Code	Description	D	L	d6g	d1	d2	l	s	Δ
24990	I.731/20+x-M4	13.5	20	M4	11	11	8	2	6
24991	I.731/20+x-M5	13.5	20	M5	11	11	10	2.5	9
24995	I.731/23+x-M5	16	23	M5	12.5	13	10	2.5	11

Revolving handles

Technopolymer

MATERIAL

Polyamide based (PA) technopolymer, black colour, matte finish.

STANDARD EXECUTION

Zinc-plated steel shank, hexagon socket at threaded end.

FEATURES AND APPLICATIONS

The grooves cut into the cylindrical surface allow an effective and ergonomic grip, though necessarily limited to the fingertips, due to the small size of the handle.



ELESA Original design

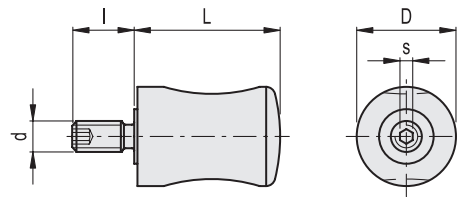

Code	Description	D	L	d6g	l	s	Δ
25004	I.741/20+x-M4	12	20	M4	8	2	8.5
25005	I.741/20+x-M5	12	20	M5	10	2.5	9
25014	I.741/23-1+x-M4	13	23	M4	8	2	9.5
25015	I.741/23-1+x-M5	13	23	M5	10	2.5	10
25017	I.741/23-2+x-M5	14.5	23	M5	10	2.5	11

