

Levers for PR-CH flush pull handles

Steel or stainless steel

STANDARD EXECUTIONS

- LPR: zinc-plated steel lever.
- LPR-SST: AISI 304 stainless steel lever.

Assembly on handle PR-CH

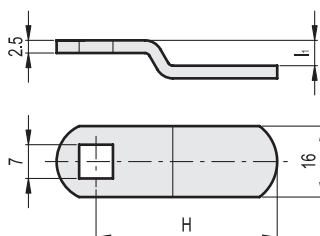
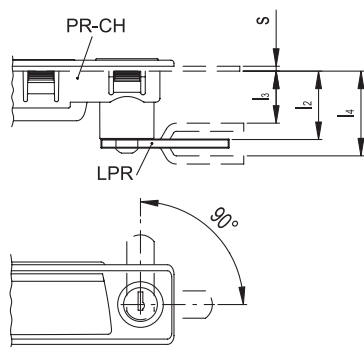

LPR

Code	Description	H	l ₁	s+l ₂	s+l ₃	s+l ₄	⚖
421041	LPR-0-17	17.5	0	23.2	-	-	7
421045	LPR-0-22	22	0	23.2	-	-	8
421049	LPR-0-32	32	0	23.2	-	-	11
421053	LPR-0-46	46	0	23.2	-	-	15
421057	LPR-2-24	24.5	2	-	21.2	25.2	8
421061	LPR-2-28	27.8	2	-	21.2	25.2	10
421065	LPR-2-34	34.5	2	-	21.2	25.2	12
421069	LPR-5-30	30	5	-	18.2	28.2	10
421073	LPR-5-33	33	5	-	18.2	28.2	11
421077	LPR-5-35	35.5	5	-	18.2	28.2	12
421081	LPR-8-32	32.5	8	-	15.2	31.2	13
421085	LPR-12-26	26.5	12	-	11.2	35.2	11

LPR-SST

Code	Description	H	l ₁	s+l ₂	s+l ₃	s+l ₄	⚖
421046	LPR-0-20-SST	19.8	0	23.2	-	-	8
421050	LPR-0-32-SST	32	0	23.2	-	-	11
421054	LPR-0-46-SST	46	0	23.2	-	-	15
421068	LPR-3-45-SST	45	3	-	20.2	26.2	15