

Levelling feet

Technopolymer base, SUPER-technopolymer stem

BASE

Glass-fibre reinforced polyamide based (PA) technopolymer, black colour, matte finish.

ARTICULATED STEM

Glass-fibre reinforced polyamide based (PA) SUPER-technopolymer, with hexagonal socket and regulation hexagon.

STANDARD EXECUTIONS

- **LV.A-STP**: without no-slip disk.
- **LV.A-AS-STP**: with NBR rubber no-slip disk, hardness 70 Shore A, supplied assembled to the base.

FEATURES

Thanks to the property of the SUPER-technopolymer stem, high rigidity and mechanical resistance are obtained in addition to natural resistance to corrosion.

The special knurling under the lower lip of the base provides excellent stability and grip when using the levelling element without no-slip disk even on surfaces that are not perfectly flat.

The particular assembling system of the no-slip disk to the base assures a perfect anchoring, preventing separation even in case of impact during transport or of adhesion (sticking) to the floor (see No-slip disk).

ORDER INFORMATION

The levelling feet are supplied unassembled to make carriage and storage easier. The components (base and stem) are supplied in separate packing: less volume taken and better protection from scratches and dirt.

To order bases and stems separately, see:

- table of possible combinations Bases/Stems
- the codes of the Bases
- the codes of the Stems

ACCESSORIES ON REQUEST

NT.: AISI 304 stainless steel or zinc-plated steel nut.



ELESA Original design

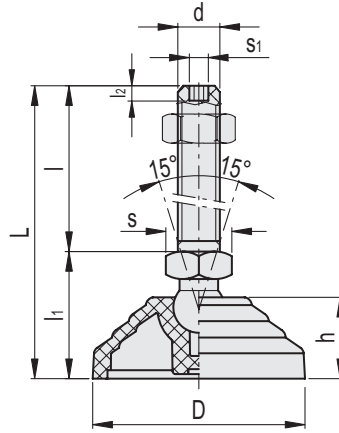

LV.A-STP

Code	Description	D	d	L	l	li	l2	h	s	s1	Articulation ∅	Max. limit static load* [N]	
303123	LV.A-60-14-STP-M8x44	60	M8	78.5	44	34.5	5	24	16	3	14	2700	40
303127	LV.A-60-14-STP-M8x69	60	M8	103.5	69	34.5	5	24	16	3	14	2700	41.5
303223	LV.A-60-14-STP-M10x44	60	M10	78.5	44	34.5	6	24	16	4	14	4800	41.5
303227	LV.A-60-14-STP-M10x69	60	M10	103.5	69	34.5	6	24	16	4	14	5000	44
303233	LV.A-60-14-STP-M10x99	60	M10	133.5	99	34.5	6	24	16	4	14	5100	47
303323	LV.A-60-14-STP-M12x44	60	M12	78.5	44	34.5	7	24	16	5	14	6800	43
303327	LV.A-60-14-STP-M12x69	60	M12	103.5	69	34.5	7	24	16	5	14	7000	47
303333	LV.A-60-14-STP-M12x99	60	M12	133.5	99	34.5	7	24	16	5	14	7000	51.5
304007	LV.A-70-14-STP-M8x44	70	M8	74.5	44	30.5	5	19	16	3	14	2700	38
304013	LV.A-70-14-STP-M8x69	70	M8	99.5	69	30.5	5	19	16	3	14	2700	39.5
304023	LV.A-70-14-STP-M10x44	70	M10	74.5	44	30.5	6	19	16	4	14	4800	39.5
304027	LV.A-70-14-STP-M10x69	70	M10	99.5	69	30.5	6	19	16	4	14	5000	42
304033	LV.A-70-14-STP-M10x99	70	M10	129.5	99	30.5	6	19	16	4	14	5100	45
304063	LV.A-70-14-STP-M12x44	70	M12	74.5	44	30.5	7	19	16	5	14	6800	41
304067	LV.A-70-14-STP-M12x69	70	M12	99.5	69	30.5	7	19	16	5	14	7000	45
304073	LV.A-70-14-STP-M12x99	70	M12	129.5	99	30.5	7	19	16	5	14	7000	49.5
304123	LV.A-80-14-STP-M8x44	80	M8	79.5	44	35.5	5	24	16	3	14	2700	61
304127	LV.A-80-14-STP-M8x69	80	M8	104.5	69	35.5	5	24	16	3	14	2700	62.5
304223	LV.A-80-14-STP-M10x44	80	M10	79.5	44	35.5	6	24	16	4	14	4800	62.5
304227	LV.A-80-14-STP-M10x69	80	M10	104.5	69	35.5	6	24	16	4	14	5000	65
304233	LV.A-80-14-STP-M10x99	80	M10	134.5	99	35.5	6	24	16	4	14	5100	68
304323	LV.A-80-14-STP-M12x44	80	M12	79.5	44	35.5	7	24	16	5	14	6800	64
304327	LV.A-80-14-STP-M12x69	80	M12	104.5	69	35.5	7	24	16	5	14	7000	68
304333	LV.A-80-14-STP-M12x99	80	M12	134.5	99	35.5	7	24	16	5	14	7000	72.5
305452	LV.A-100-14-STP-M8x44	100	M8	79	44	35	5	24	16	3	14	2700	90
305455	LV.A-100-14-STP-M8x69	100	M8	104	69	35	5	24	16	3	14	2700	91.5
305462	LV.A-100-14-STP-M10x44	100	M10	79	44	35	6	24	16	4	14	4800	91.5
305464	LV.A-100-14-STP-M10x69	100	M10	104	69	35	6	24	16	4	14	5000	94
305467	LV.A-100-14-STP-M10x99	100	M10	134	99	35	6	24	16	4	14	5100	97
305472	LV.A-100-14-STP-M12x44	100	M12	79	44	35	7	24	16	5	14	6800	93
305474	LV.A-100-14-STP-M12x69	100	M12	104	69	35	7	24	16	5	14	7000	97
305476	LV.A-100-14-STP-M12x99	100	M12	134	99	35	7	24	16	5	14	7000	101.5

* The max static load is the value above which the load applied to the element may cause some plastic material breakage, in particular conditions of use. Obviously, a factor that takes into consideration the importance and the safety level of the specific application must be applied to this value.



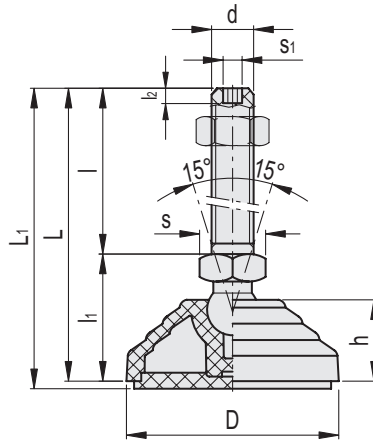

LV.A-AS-STP

Code	Description	D	d	L	L1	l	li	l2	h	s	s1	Articulation Ø	Max. limit static load* [N]	⚖️
307123	LV.A-60-14-AS-STP-M8x44	60	M8	78.5	81.5	44	34.5	5	24	16	3	14	2700	59
307127	LV.A-60-14-AS-STP-M8x69	60	M8	103.5	106.5	69	34.5	5	24	16	3	14	2700	60.5
307223	LV.A-60-14-AS-STP-M10x44	60	M10	78.5	81.5	44	34.5	6	24	16	4	14	4800	60.5
307227	LV.A-60-14-AS-STP-M10x69	60	M10	103.5	106.5	69	34.5	6	24	16	4	14	5000	63
307233	LV.A-60-14-AS-STP-M10x99	60	M10	133.5	136.5	99	34.5	6	24	16	4	14	5100	66
307323	LV.A-60-14-AS-STP-M12x44	60	M12	78.5	81.5	44	34.5	7	24	16	5	14	6800	62
307327	LV.A-60-14-AS-STP-M12x69	60	M12	103.5	106.5	69	34.5	7	24	16	5	14	7000	66
307333	LV.A-60-14-AS-STP-M12x99	60	M12	133.5	136.5	99	34.5	7	24	16	5	14	7000	70.5
308007	LV.A-70-14-AS-STP-M8x44	70	M8	74.5	77.5	44	30.5	5	19	16	3	14	2700	58
308013	LV.A-70-14-AS-STP-M8x69	70	M8	99.5	102.5	69	30.5	5	19	16	3	14	2700	59.5
308023	LV.A-70-14-AS-STP-M10x44	70	M10	74.5	77.5	44	30.5	6	19	16	4	14	4800	59.5
308027	LV.A-70-14-AS-STP-M10x69	70	M10	99.5	102.5	69	30.5	6	19	16	4	14	5000	62
308033	LV.A-70-14-AS-STP-M10x99	70	M10	129.5	132.5	99	30.5	6	19	16	4	14	5100	65
308063	LV.A-70-14-AS-STP-M12x44	70	M12	74.5	77.5	44	30.5	7	19	16	5	14	6800	61
308067	LV.A-70-14-AS-STP-M12x69	70	M12	99.5	102.5	69	30.5	7	19	16	5	14	7000	65
308073	LV.A-70-14-AS-STP-M12x99	70	M12	129.5	132.5	99	30.5	7	19	16	5	14	7000	69.5
308123	LV.A-80-14-AS-STP-M8x44	80	M8	79.5	82.5	44	35.5	5	24	16	3	14	2700	87
308127	LV.A-80-14-AS-STP-M8x69	80	M8	104.5	107.5	69	35.5	5	24	16	3	14	2700	88.5
308223	LV.A-80-14-AS-STP-M10x44	80	M10	79.5	82.5	44	35.5	6	24	16	4	14	4800	88.5
308227	LV.A-80-14-AS-STP-M10x69	80	M10	104.5	107.5	69	35.5	6	24	16	4	14	5000	91
308233	LV.A-80-14-AS-STP-M10x99	80	M10	134.5	137.5	99	35.5	6	24	16	4	14	5100	94
308323	LV.A-80-14-AS-STP-M12x44	80	M12	79.5	82.5	44	35.5	7	24	16	5	14	6800	90
308327	LV.A-80-14-AS-STP-M12x69	80	M12	104.5	107.5	69	35.5	7	24	16	5	14	7000	94
308333	LV.A-80-14-AS-STP-M12x99	80	M12	134.5	137.5	99	35.5	7	24	16	5	14	7000	98.5
309452	LV.A-100-14-AS-STP-M8x44	100	M8	79	82	44	35	5	24	16	3	14	2700	144
309454	LV.A-100-14-AS-STP-M8x69	100	M8	104	107	69	35	5	24	16	3	14	2700	145.5
309462	LV.A-100-14-AS-STP-M10x44	100	M10	79	82	44	35	6	24	16	4	14	4800	145.5
309464	LV.A-100-14-AS-STP-M10x69	100	M10	104	107	69	35	6	24	16	4	14	5000	148
309466	LV.A-100-14-AS-STP-M10x99	100	M10	134	137	99	35	6	24	16	4	14	5100	151
309472	LV.A-100-14-AS-STP-M12x44	100	M12	79	82	44	35	7	24	16	5	14	6800	147
309474	LV.A-100-14-AS-STP-M12x69	100	M12	104	107	69	35	7	24	16	5	14	7000	151
309476	LV.A-100-14-AS-STP-M12x99	100	M12	134	137	99	35	7	24	16	5	14	7000	155.5

* The max static load is the value above which the load applied to the element may cause some plastic material breakage, in particular conditions of use. Obviously, a factor that takes into consideration the importance and the safety level of the specific application must be applied to this value.

Levelling elements 11