

## Twin castors for the general public with steel bracket

### Vulcanised rubber coating

#### COVERING

Grey anti-trace rubber.

#### WHEEL CENTRE BODY

Polypropylene-based (PP) technopolymer.

#### ROLLING ACTION

Hub with pass-through hole.

#### TURNING PLATE BRACKET

Electrolytically zinc-plated steel sheet bracket.

The presence of a double ball race and the direct contact between the plate and the ball race ring with built-in pin ensure excellent manoeuvrability.

#### FRONT-ACTUATED BRAKE

Total brake that locks rotation of the wheel and the technopolymer bracket.

The optimised dimensions and the retractable pedal ensure minimal space occupied and maximum actuation ease.

#### STANDARD EXECUTIONS

- **SBL-G**: turning plate bracket, without brake.
- **SBF-G**: turning plate bracket, with brake.
- **CBL-G**: turning plate bracket and threaded centre pin, without brake.
- **CBF-G**: turning plate bracket and threaded centre pin, with brake.

#### APPLICATIONS

Wheels for the general public with high carrying capacity, excellent smoothness and elasticity features.

#### ENVIRONMENTAL CONDITIONS

The twin wheels RE.C7-G are suitable for use in humid environments and in the presence of medium-aggressive chemical environments; use in environments with the presence of organic, chlorinated solvents, hydrocarbons and mineral oils is not recommended.



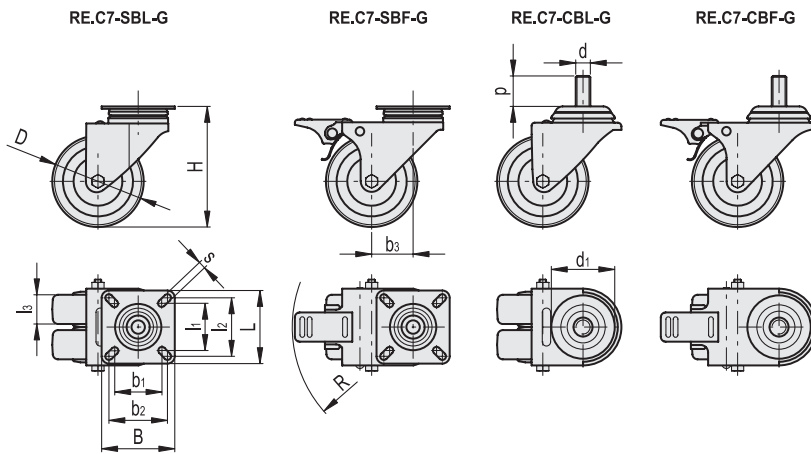

RE.C7-SBL-G

Code	Description	D	l <sub>1</sub>	l <sub>2</sub>	l <sub>3</sub>	b <sub>1</sub>	b <sub>2</sub>	b <sub>3</sub>	H	B	L	s	Dynamic carrying capacity# [N]	⚖️
452002	RE.C7-050-SBL-G	50	38.5	48	18	38.5	48	30	70	60	60	6	600	350
452010	RE.C7-075-SBL-G	75	38.5	48	24	38.5	48	33	100	60	60	6	800	640

RE.C7-SBF-G

Code	Description	D	l <sub>1</sub>	l <sub>2</sub>	l <sub>3</sub>	b <sub>1</sub>	b <sub>2</sub>	b <sub>3</sub>	H	B	L	s	R	Dynamic carrying capacity# [N]	⚖️
452052	RE.C7-050-SBF-G	50	38.5	48	18	38.5	48	30	70	60	60	6	83	600	400
452050	RE.C7-075-SBF-G	75	38.5	48	24	38.5	48	33	100	60	60	6	95	800	720

RE.C7-CBL-G

Code	Description	D	d	p	d <sub>1</sub>	l <sub>3</sub>	b <sub>3</sub>	H	Dynamic carrying capacity# [N]	⚖️
452152	RE.C7-050-CBL-G	50	M10	15	42	18	30	70	600	300
452160	RE.C7-075-CBL-G	75	M12	25	52	24	33	100	800	500

RE.C7-CBF-G

Code	Description	D	d	p	d <sub>1</sub>	l <sub>3</sub>	b <sub>3</sub>	H	R	Dynamic carrying capacity# [N]	⚖️
452202	RE.C7-050-CBF-G	50	M10	15	42	18	30	70	83	600	370
452210	RE.C7-075-CBF-G	75	M12	25	52	24	33	100	95	800	680

# For dynamic carrying capacity see Technical data (on page -).

