

Thermoplastic rubber wheels

Technopolymer centre body

COVERING

Grey anti-trace thermoplastic wheel, hardness 85 Shore A.

WHEEL CENTRE BODY

Polypropylene-based technopolymer (PP).

ROLLING ACTION

Hub with pass-through hole.

APPLICATIONS

Excellent smoothness and elasticity features. For selection parameters see Technical data (on page -).

RE.G1 wheels are also supplied with steel sheet bracket (RE.G1-N on page -).

ENVIRONMENTAL CONDITIONS

Suitable for use in humid environments and in the presence of medium-aggressive chemicals; use in environments with the presence of organic, chlorinated solvents, hydrocarbons and mineral oils is not recommended.

ROLLING RESISTANCE - FORCE / LOAD APPLIED

For each load and diameter, the table indicates the force (in N) needed to push or pull a single wheel at a constant speed of 4 km/h on smooth ground.

For manual handling of a 4-wheel trolley, it is recommended to choose diameters with values below 50 N; for frequent handling, choose values below 30 N.

MECHANICAL MOVING WITH TOWING DEVICES

For mechanical towing, please see the technical specifications to determine the capacity variation.

TEMPERATURE

If operating temperatures in an application differ from the standard range of values, please see the technical specifications to determine the capacity variation.



		Traction force or thrust for wheel movement [N]				
		Load [N]				
		500	1000	1500	2000	2250
D [mm]	80	35	-	-	-	-
	100	22	50	-	-	-
	125	15	35	-	-	-
	150	<10	20	38	-	-

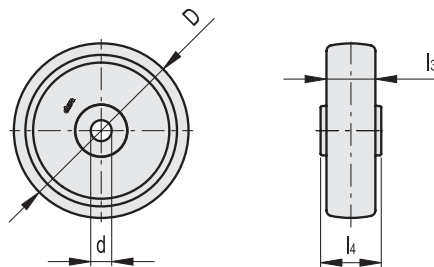

Code	Description	D	d	l ₃	l ₄	Static load# [N]	Rolling resistance# [N]	Dynamic carrying capacity# [N]	⚖️
452501	RE.G1-080-RBL	80	12	30	39	1000	700	700	90
452506	RE.G1-100-RBL	100	12	30	44	1500	1000	1000	120
452511	RE.G1-125-RBL	125	15	35	44	1800	1200	1200	200
452516	RE.G1-150-RBL	150	20	45	59	2700	1800	1800	360

For static load, rolling resistance and dynamic carrying capacity see Technical data (on page -).