

Breather caps

Technopolymer

COVER

- Polyamide based (PA) technopolymer, semi-matte finish.
- SFN.: RAL 2004 orange, marked "OIL".
- SFN.....-C9: RAL 9005 black colour, marked "OIL".
- SFN.....-C2-N: RAL 2004 orange, without "OIL" mark.
- SFN.....-C9-N: RAL 9005 black colour, without "OIL" mark.

THREADED FITTING

Polyamide based (PA) technopolymer, black colour, semi-matte finish.

PACKING RING

NBR synthetic rubber.

STANDARD EXECUTIONS

- **SFN.**: without air filter.
 - **SFN+F**: with "tech-foam" air filter in polyurethane foam mesh (polyester base), air filtration 40 μ .
 - **SFN-BA+F**: with "tech-foam" air filter in polyurethane foam mesh (polyester base), air filtration 40 μ .
- Zinc-plated steel sheet bayonet.
Chrome-plated steel safety chain.

MAXIMUM CONTINUOUS WORKING TEMPERATURE

100°C.

FEATURES AND APPLICATIONS

SFN. breather caps, owing to their high air flow rate, are particularly suitable for use on hydraulic power packs or tanks subject to rapid changes in liquid volume.

TECHNICAL DATA

Air flow rate for each model can be determined from the graph calculating the difference between the pressure inside and outside the reservoir.

SPECIAL EXECUTION ON REQUEST

Threaded connector also with NPT thread (National Taper Pipe Thread - ANSI-ASME B1-20) for the codes marked with # in the table.



ELESA Original design

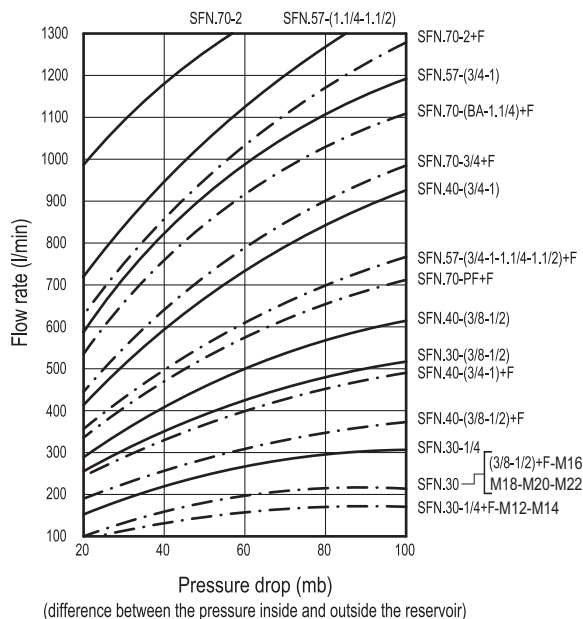

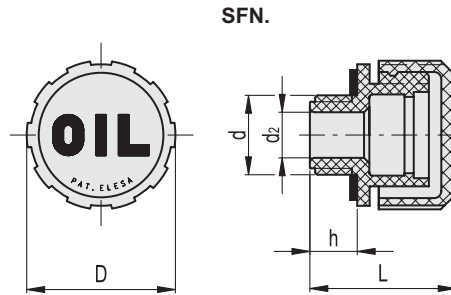

SFN.

Code	Description	D	d	L	d2	h	⚠
53895	SFN.30-12x1.5	31	M12x1.5	29.5	6	9.5	10
53895-C9	SFN.30-12x1.5-C9	31	M12x1.5	29.5	6	9.5	10
53896	SFN.30-14x1.5	31	M14x1.5	29.5	8	9.5	10
53896-C9	SFN.30-14x1.5-C9	31	M14x1.5	29.5	8	9.5	10
53871	SFN.30-16x1.5	31	M16x1.5	29.5	10	9	10
53871-C9	SFN.30-16x1.5-C9	31	M16x1.5	29.5	10	9	10
53881	SFN.30-18x1.5	31	M18x1.5	29.5	10	9	10
53881-C9	SFN.30-18x1.5-C9	31	M18x1.5	29.5	10	9	10
53886	SFN.30-20x1.5	31	M20x1.5	29.5	10	9	11
53886-C9	SFN.30-20x1.5-C9	31	M20x1.5	29.5	10	9	11
53891	SFN.30-22x1.5	31	M22x1.5	29.5	13.5	9	11
53891-C9	SFN.30-22x1.5-C9	31	M22x1.5	29.5	13.5	9	11
56151	SFN.30-1/4#	31	G1/4	29.5	8	9.5	10
56151-C9	SFN.30-1/4-C9#	31	G1/4	29.5	8	9.5	10
53901	SFN.30-3/8	31	G3/8	29.5	10	9.5	11
53901-C9	SFN.30-3/8-C9	31	G3/8	29.5	10	9.5	11
53911	SFN.30-1/2	31	G1/2	29.5	12	9.5	12
53911-C9	SFN.30-1/2-C9	31	G1/2	29.5	12	9.5	12
56181	SFN.40-3/8#	42	G3/8	36.5	10	11.5	21
56181-C9	SFN.40-3/8-C9#	42	G3/8	36.5	10	11.5	21
56201	SFN.40-1/2#	42	G1/2	36.5	12	11.5	22
56201-C9	SFN.40-1/2-C9#	42	G1/2	36.5	12	11.5	22
53921	SFN.40-3/4#	42	G3/4	36.5	18	11.5	24
53921-C9	SFN.40-3/4-C9#	42	G3/4	36.5	18	11.5	24
53931	SFN.40-1	42	G1	36.5	18	11.5	23
53931-C9	SFN.40-1-C9	42	G1	36.5	18	11.5	23
56241	SFN.57-3/4#	57	G3/4	42	18	14	42
56241-C9	SFN.57-3/4-C9#	57	G3/4	42	18	14	42
56261	SFN.57-1	57	G1	42	23	14	40
56261-C9	SFN.57-1-C9	57	G1	42	23	14	42
53932	SFN.57-1¼	57	G1¼	44	28	16	44
53932-C9	SFN.57-1¼-C9	57	G1¼	44	28	16	44
53933	SFN.57-1½	57	G1½	44	28	16	44
53933-C9	SFN.57-1½-C9	57	G1½	44	28	16	43
56381	SFN.70-2	70	G2	59	23	17	84
56381-C9	SFN.70-2-C9	70	G2	59	23	17	84

Types available on request with NPT thread (National Taper Pipe Thread - ANSI-ASME B1-20).



1
2
3
4
5
6
7
8
9
10
11
12
13
14
15
16
17
18
19
20
21
22
23

 Accessories for hydraulic systems 15

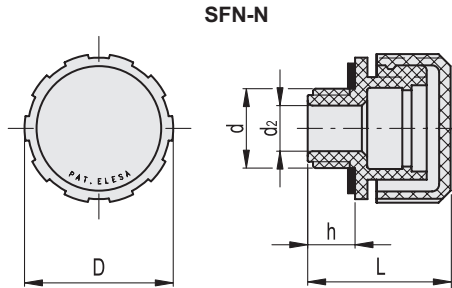

SFN-N

Code	Description	D	d	L	dz	h	⚖
53895-C2-N	SFN.30-12x1.5-C2-N	31	M12x1.5	29.5	6	9.5	10
53895-C9-N	SFN.30-12x1.5-C9-N	31	M12x1.5	29.5	6	9.5	10
53896-C2-N	SFN.30-14x1.5-C2-N	31	M14x1.5	29.5	8	9.5	10
53896-C9-N	SFN.30-14x1.5-C9-N	31	M14x1.5	29.5	8	9.5	10
53871-C2-N	SFN.30-16x1.5-C2-N	31	M16x1.5	29.5	10	9	10
53871-C9-N	SFN.30-16x1.5-C9-N	31	M16x1.5	29.5	10	9	10
53881-C2-N	SFN.30-18x1.5-C2-N	31	M18x1.5	29.5	10	9	10
53881-C9-N	SFN.30-18x1.5-C9-N	31	M18x1.5	29.5	10	9	10
53886-C2-N	SFN.30-20x1.5-C2-N	31	M20x1.5	29.5	10	9	11
53886-C9-N	SFN.30-20x1.5-C9-N	31	M20x1.5	29.5	10	9	11
53891-C2-N	SFN.30-22x1.5-C2-N	31	M22x1.5	29.5	13.5	9	11
53891-C9-N	SFN.30-22x1.5-C9-N	31	M22x1.5	29.5	13.5	9	11
56151-C2-N	SFN.30-1/4-C2-N#	31	G1/4	29.5	8	9.5	10
56151-C9-N	SFN.30-1/4-C9-N#	31	G1/4	29.5	8	9.5	10
53901-C2-N	SFN.30-3/8-C2-N	31	G3/8	29.5	10	9.5	11
53901-C9-N	SFN.30-3/8-C9-N	31	G3/8	29.5	10	9.5	11
53911-C2-N	SFN.30-1/2-C2-N	31	G1/2	29.5	12	9.5	12
53911-C9-N	SFN.30-1/2-C9-N	31	G1/2	29.5	12	9.5	12
56181-C2-N	SFN.40-3/8-C2-N#	42	G3/8	36.5	10	11.5	21
56181-C9-N	SFN.40-3/8-C9-N#	42	G3/8	36.5	10	11.5	21
56201-C2-N	SFN.40-1/2-C2-N#	42	G1/2	36.5	12	11.5	22
56201-C9-N	SFN.40-1/2-C9-N#	42	G1/2	36.5	12	11.5	22
53921-C2-N	SFN.40-3/4-C2-N#	42	G3/4	36.5	18	11.5	24
53921-C9-N	SFN.40-3/4-C9-N#	42	G3/4	36.5	18	11.5	24
53931-C2-N	SFN.40-1-C2-N	42	G1	36.5	18	11.5	23
53931-C9-N	SFN.40-1-C9-N	42	G1	36.5	18	11.5	23
56241-C2-N	SFN.57-3/4-C2-N#	57	G3/4	42	18	14	42
56241-C9-N	SFN.57-3/4-C9-N#	57	G3/4	42	18	14	42
56261-C2-N	SFN.57-1-C2-N	57	G1	42	23	14	42
56261-C9-N	SFN.57-1-C9-N	57	G1	42	23	14	42
53932-C2-N	SFN.57-1/4-C2-N	57	G11/4	44	28	16	44
53932-C9-N	SFN.57-1/4-C9-N	57	G11/4	44	28	16	44
53933-C2-N	SFN.57-1/2-C2-N	57	G11/2	44	28	16	43
53933-C9-N	SFN.57-1/2-C9-N	57	G11/2	44	28	16	43
56381-C2-N	SFN.70-2-C2-N	70	G2	59	23	17	84
56381-C9-N	SFN.70-2-C9-N	70	G2	59	23	17	84

Types available on request with NPT thread (National Taper Pipe Thread - ANSI-ASME B1-20).

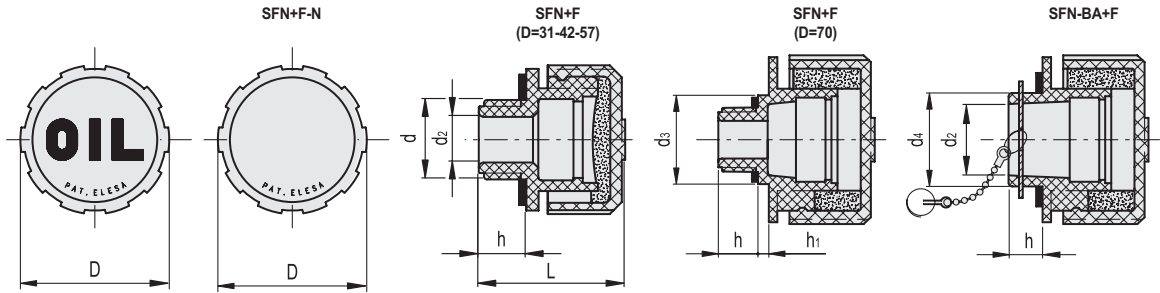

SFN+F

Code	Description	D	d	L	d ₂	d ₃	h	h ₁	⚖
56081	SFN.30-12x1.5+F	31	M12x1.5	29.5	6	-	9.5	-	10
56081-C9	SFN.30-12x1.5+F-C9	31	M12x1.5	29.5	6	-	9.5	-	10
56091	SFN.30-14x1.5+F	31	M14x1.5	29.5	8	-	9.5	-	10
56091-C9	SFN.30-14x1.5+F-C9	31	M14x1.5	29.5	8	-	9.5	-	10
56101	SFN.30-16x1.5+F	31	M16x1.5	29.5	10	-	9	-	10
56101-C9	SFN.30-16x1.5+F-C9	31	M16x1.5	29.5	10	-	9	-	10
56111	SFN.30-18x1.5+F	31	M18x1.5	29.5	10	-	9	-	10
56111-C9	SFN.30-18x1.5+F-C9	31	M18x1.5	29.5	10	-	9	-	10
56131	SFN.30-20x1.5+F	31	M20x1.5	29.5	10	-	9	-	11
56131-C9	SFN.30-20x1.5+F-C9	31	M20x1.5	29.5	10	-	9	-	11
56141	SFN.30-22x1.5+F	31	M22x1.5	29.5	13.5	-	9	-	11
56141-C9	SFN.30-22x1.5+F-C9	31	M22x1.5	29.5	13.5	-	9	-	11
56156	SFN.30-1/4+F#	31	G1/4	29.5	8	-	9.5	-	10
56156-C9	SFN.30-1/4+F-C9#	31	G1/4	29.5	8	-	9.5	-	10
56161	SFN.30-3/8+F	31	G3/8	29.5	10	-	9.5	-	11
56161-C9	SFN.30-3/8+F-C9	31	G3/8	29.5	10	-	9.5	-	11
56171	SFN.30-1/2+F	31	G1/2	29.5	12	-	9.5	-	11
56171-C9	SFN.30-1/2+F-C9	31	G1/2	29.5	12	-	9.5	-	11
56191	SFN.40-3/8+F#	42	G3/8	36.5	10	-	11.5	-	21
56191-C9	SFN.40-3/8+F-C9#	42	G3/8	36.5	10	-	11.5	-	21
56211	SFN.40-1/2+F#	42	G1/2	36.5	12	-	11.5	-	23
56211-C9	SFN.40-1/2+F-C9#	42	G1/2	36.5	12	-	11.5	-	23
56221	SFN.40-3/4+F#	42	G3/4	36.5	18	-	11.5	-	23
56221-C9	SFN.40-3/4+F-C9#	42	G3/4	36.5	18	-	11.5	-	22
56231	SFN.40-1+F	42	G1	36.5	18	-	11.5	-	24
56231-C9	SFN.40-1+F-C9	42	G1	36.5	18	-	11.5	-	24
56251	SFN.57-3/4+F#	57	G3/4	42	18	-	14	-	40
56251-C9	SFN.57-3/4+F-C9#	57	G3/4	42	18	-	14	-	40
56271	SFN.57-1+F	57	G1	42	23	-	14	-	42
56271-C9	SFN.57-1+F-C9	57	G1	42	23	-	14	-	42
56281	SFN.57-1¼+F	57	G1¼	44	28	-	16	-	44
56281-C9	SFN.57-1¼+F-C9	57	G1¼	44	28	-	16	-	44
56291	SFN.57-1½+F	57	G1½	44	28	-	16	-	45
56291-C9	SFN.57-1½+F-C9	57	G1½	44	28	-	16	-	45
54701	SFN.70-3/4+F#	70	G3/4	63	16	35	15	6	82
54701-C9	SFN.70-3/4+F-C9#	70	G3/4	63	16	35	15	6	77
54711	SFN.70-1¼+F	70	G1¼	59	23	-	17	-	81
54711-C9	SFN.70-1¼+F-C9	70	G1¼	59	23	-	17	-	81
56391	SFN.70-2+F	70	G2	59	23	-	17	-	91
56391-C9	SFN.70-2+F-C9	70	G2	59	23	-	17	-	91

Types available on request with NPT thread (National Taper Pipe Thread - ANSI-ASME B1-20).



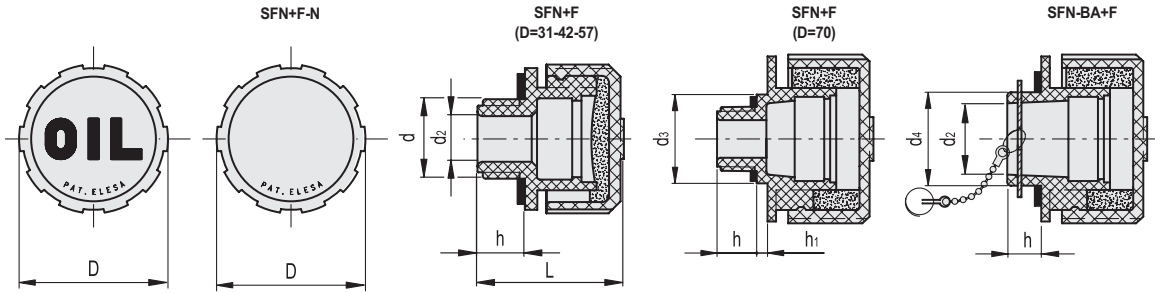

SFN+F-N

Code	Description	D	d	L	d2	d3	h	h1	⚖
56081-C2-N	SFN.30-12x1.5+F-C2-N	31	M12x1.5	29.5	6	-	9.5	-	10
56081-C9-N	SFN.30-12x1.5+F-C9-N	31	M12x1.5	29.5	6	-	9.5	-	10
56091-C2-N	SFN.30-14x1.5+F-C2-N	31	M14x1.5	29.5	8	-	9.5	-	10
56091-C9-N	SFN.30-14x1.5+F-C9-N	31	M14x1.5	29.5	8	-	9.5	-	10
56101-C2-N	SFN.30-16x1.5+F-C2-N	31	M16x1.5	29.5	10	-	9	-	10
56101-C9-N	SFN.30-16x1.5+F-C9-N	31	M16x1.5	29.5	10	-	9	-	10
56111-C2-N	SFN.30-18x1.5+F-C2-N	31	M18x1.5	29.5	10	-	9	-	10
56111-C9-N	SFN.30-18x1.5+F-C9-N	31	M18x1.5	29.5	10	-	9	-	10
56131-C2-N	SFN.30-20x1.5+F-C2-N	31	M20x1.5	29.5	10	-	9	-	11
56131-C9-N	SFN.30-20x1.5+F-C9-N	31	M20x1.5	29.5	10	-	9	-	11
56141-C2-N	SFN.30-22x1.5+F-C2-N	31	M22x1.5	29.5	13.5	-	9	-	11
56141-C9-N	SFN.30-22x1.5+F-C9-N	31	M22x1.5	29.5	13.5	-	9	-	11
56156-C2-N	SFN.30-1/4+F-C2-N#	31	G1/4	29.5	8	-	9.5	-	10
56156-C9-N	SFN.30-1/4+F-C9-N#	31	G1/4	29.5	8	-	9.5	-	10
56161-C2-N	SFN.30-3/8+F-C2-N	31	G3/8	29.5	10	-	9.5	-	11
56161-C9-N	SFN.30-3/8+F-C9-N	31	G3/8	29.5	10	-	9.5	-	11
56171-C2-N	SFN.30-1/2+F-C2-N	31	G1/2	29.5	12	-	9.5	-	11
56171-C9-N	SFN.30-1/2+F-C9-N	31	G1/2	29.5	12	-	9.5	-	11
56191-C2-N	SFN.40-3/8+F-C2-N#	42	G3/8	36.5	10	-	11.5	-	21
56191-C9-N	SFN.40-3/8+F-C9-N#	42	G3/8	36.5	10	-	11.5	-	21
56211-C2-N	SFN.40-1/2+F-C2-N#	42	G1/2	36.5	12	-	11.5	-	23
56211-C9-N	SFN.40-1/2+F-C9-N#	42	G1/2	36.5	12	-	11.5	-	23
56221-C2-N	SFN.40-3/4+F-C2-N#	42	G3/4	36.5	18	-	11.5	-	22
56221-C9-N	SFN.40-3/4+F-C9-N#	42	G3/4	36.5	18	-	11.5	-	22
56231-C2-N	SFN.40-1+F-C2-N	42	G1	36.5	18	-	11.5	-	24
56231-C9-N	SFN.40-1+F-C9-N	42	G1	36.5	18	-	11.5	-	24
56251-C2-N	SFN.57-3/4+F-C2-N#	57	G3/4	42	18	-	14	-	40
56251-C9-N	SFN.57-3/4+F-C9-N#	57	G3/4	42	18	-	14	-	40
56271-C2-N	SFN.57-1+F-C2-N	57	G1	42	23	-	14	-	42
56271-C9-N	SFN.57-1+F-C9-N	57	G1	42	23	-	14	-	42
56281-C2-N	SFN.57-1¼+F-C2-N	57	G1¼	44	28	-	16	-	44
56281-C9-N	SFN.57-1¼+F-C9-N	57	G1¼	44	28	-	16	-	44
56291-C2-N	SFN.57-1½+F-C2-N	57	G1½	44	28	-	16	-	45
56291-C9-N	SFN.57-1½+F-C9-N	57	G1½	44	28	-	16	-	45
54701-C2-N	SFN.70-3/4+F-C2-N#	70	G3/4	63	16	35	15	6	77
54701-C9-N	SFN.70-3/4+F-C9-N#	70	G3/4	63	16	35	15	6	77
54711-C2-N	SFN.70-1¼+F-C2-N	70	G1¼	59	23	-	17	-	81
54711-C9-N	SFN.70-1¼+F-C9-N	70	G1¼	59	23	-	17	-	81
56391-C2-N	SFN.70-2+F-C2-N	70	G2	59	23	-	17	-	91
56391-C9-N	SFN.70-2+F-C9-N	70	G2	59	23	-	17	-	91

Types available on request with NPT thread (National Taper Pipe Thread - ANSI-ASME B1-20).

SFN-BA+F

Code	Description	D	L	d2	d4	h	⚖
54731	SFN.70-BA+F	70	56	23	39	14	90
54731-C9	SFN.70-BA+F-C9	70	56	23	39	14	90

SFN-BA+F-N

Code	Description	D	L	d2	d4	h	⚖
54731-C2-N	SFN.70-BA+F-C2-N	70	56	23	39	14	90
54731-C9-N	SFN.70-BA+F-C9-N	70	56	23	39	14	90