

# T.440



# T.440+a



## Plugs

### Technopolymer

#### MATERIAL

Polyamide based (PA) technopolymer, black colour, matte finish.

#### PACKING RING

NBR synthetic rubber.

#### MAXIMUM CONTINUOUS WORKING TEMPERATURE

100°C.

#### SPECIAL EXECUTIONS ON REQUEST

Words, marks and graphic symbols can be tampoprinted on the cap.

## Plugs

### with flat dipstick, technopolymer

#### MATERIAL

Polyamide based (PA) technopolymer, black colour, matte finish.

#### PACKING RING

NBR synthetic rubber.

#### FLAT DIPSTICK

Flat section phosphatised steel.

On request and for sufficient quantities dipstick can be supplied in different lengths and/or complete with MAX-MIN level lines.

#### MAXIMUM CONTINUOUS WORKING TEMPERATURE

100°C.

#### SPECIAL EXECUTIONS ON REQUEST

Words, marks and graphic symbols can be tampoprinted on the cap.



ELESA Original design

ELESA Original design

T.440-1/4  
T.440-3/8

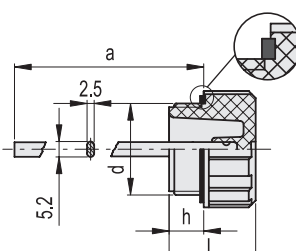
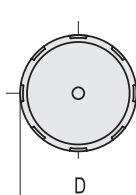
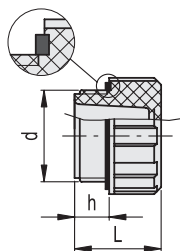
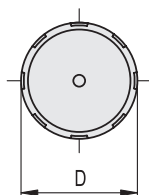
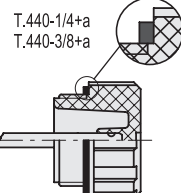
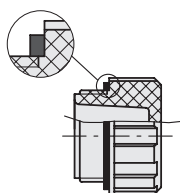

Code	Description	d	h	D	L	
157111	T.440-1/4	G 1/4	9	20.5	19	10
157121	T.440-3/8	G 3/8	9	25	21	12
157131	T.440-1/2	G 1/2	11	28.5	25	14
157141	T.440-3/4	G 3/4	12	34.5	27	22
157151	T.440-1	G 1	13	42.5	28.5	28
157161	T.440-1¼	G 1 1/4	13	52	32	52
157171	T.440-1½	G 1 1/2	13	57.5	34	63

Code	Description	d	h	D	L	a	
157211	T.440-1/4+a	G 1/4	9	20.5	19	192	30
157221	T.440-3/8+a	G 3/8	9	25	21	192	32
157231	T.440-1/2+a	G 1/2	11	28.5	25	189	42
157241	T.440-3/4+a	G 3/4	12	34.5	27	188	50
157251	T.440-1+a	G 1	13	42.5	28.5	188	56
157261	T.440-1¼+a	G 1 1/4	13	52	32	185	72
157271	T.440-1½+a	G 1 1/2	13	57.5	34	185	83